

# M-67 CONES

## Concentric Expansion Connectors

### Cones, No Flanges

Part Number	A	B	C
M-67-00-6080	6	8	9.5
M-67-00-6010	6	10	11.5
M-67-00-8010	8	10	11.5
M-67-00-8012	8	12	11.5
M-67-00-1012	10	12	11.5
M-67-00-1014	10	14	11.5
M-67-00-1214	12	14	11.5
M-67-00-1216	12	16	11.5
M-67-00-1416	14	16	13.5
M-67-00-1418	14	18	13.5
M-67-00-1618	16	18	15.5
M-67-00-1620	16	20	15.5
M-67-00-1820	18	20	15.5
M-67-00-1822	18	22	15.5
M-67-00-2022	20	22	15.5
M-67-00-2024	20	24	15.5
M-67-00-2224	22	24	15.5
M-67-00-2226	22	26	15.5

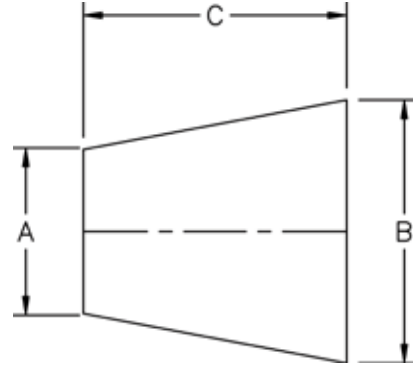

### Cones, Flanged Both Ends

Part Number	A	B	C
M-67-11-6080	6	8	10
M-67-11-6010	6	10	12
M-67-11-8010	8	10	12
M-67-11-8012	8	12	12
M-67-11-1012	10	12	12
M-67-11-1014	10	14	12
M-67-11-1214	12	14	12
M-67-11-1216	12	16	12
M-67-11-1416	14	16	14
M-67-11-1418	14	18	14
M-67-11-1618	16	18	16
M-67-11-1620	16	20	16
M-67-11-1820	18	20	16
M-67-11-1822	18	22	16
M-67-11-2022	20	22	16
M-67-11-2024	20	24	16
M-67-11-2224	22	24	16
M-67-11-2226	22	26	16

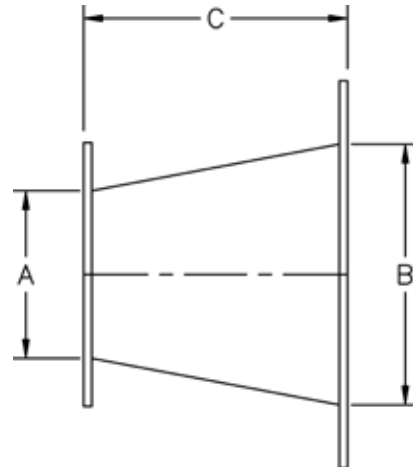

All ANSI flanges may be replaced with a standard Caterpillar, Cummins, or MTU engine flanges.

All dimensions are in inches. Larger sizes available. Available in stainless steel.

