

M-11 BELLOWS

Expansion Joints / Bellows

Floating ANSI Flange / ANSI Flange

Part Number	A	B
M-11-1F1-3512	3.5	12
M-11-1F1-412	4	12
M-11-1F1-512	5	12
M-11-1F1-612	6	12
M-11-1F1-618	6	18
M-11-1F1-812	8	12
M-11-1F1-818	8	18
M-11-1F1-1012	10	12
M-11-1F1-1018	10	18
M-11-1F1-1212	12	12
M-11-1F1-1218	12	18
M-11-1F1-1412	14	12
M-11-1F1-1418	14	18
M-11-1F1-1612	16	12
M-11-1F1-1618	16	18
M-11-1F1-1812	18	12
M-11-1F1-1818	18	18
M-11-1F1-2012	20	12
M-11-1F1-2018	20	18
M-11-1F1-2212	22	12
M-11-1F1-2218	22	18
M-11-1F1-2412	24	12
M-11-1F1-2418	24	18
M-11-1F1-2612	26	12
M-11-1F1-2618	26	18
M-11-1F1-2812	28	12
M-11-1F1-2818	28	18
M-11-1F1-3012	30	12
M-11-1F1-3018	30	18

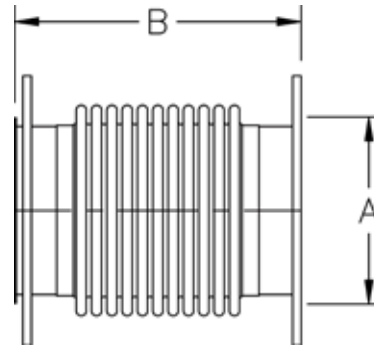

Male NPT / Male NPT

Part Number	A	B
M-11-22-3514	3.5	14
M-11-22-414	4	14
M-11-22-516	5	16
M-11-22-618	6	18

Threaded pipe nipples may be replaced with plain pipe stubs.

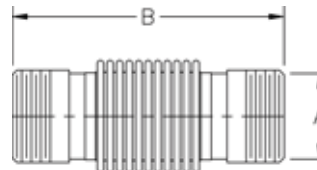

All dimensions are in inches. Other sizes available. All ANSI flanges may be replaced with a standard Caterpillar, Cummins, or MTU engine flanges. Bellows are 321 stainless steel. End connections are carbon steel. Connections available in stainless steel. Bellows flow liners are recommended for exhaust 6" and below when gas/stream flow conditions are greater than available in stainless steel. or equal to 4 ft/second/inch of diameter and for exhaust 8" and above when gas/stream flow conditions are greater than or equal to 25 ft/second.



M-11 BELLOWS

Expansion Joints / Bellows

Female Half Coupling / ANSI Flange

Part Number	A	B
M-11-31-3514	3.5	14
M-11-31-414	4	14
M-11-31-516	5	16
M-11-31-618	6	18

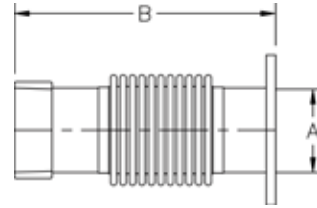

Slotted ID Cuff / ANSI Flange

Part Number	A	B
M-11-41-3514	3.5	14
M-11-41-414	4	14
M-11-41-514	5	14
M-11-41-618	6	18

Cuff may be replaced by plain tube.

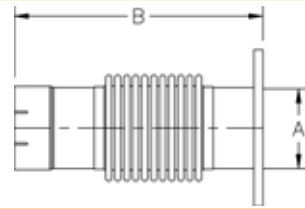

Slotted ID Cuff / Male NPT

Part Number	A	B
M-11-42-3514	3.5	14
M-11-42-414	4	14
M-11-42-516	5	16
M-11-42-618	6	18

Threaded pipe nipples may be replaced with plain pipe stubs.

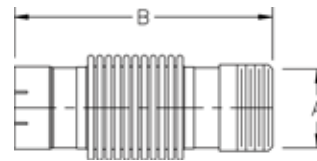

Slotted ID Cuff / Female Half Coupling

Part Number	A	B
M-11-43-3514	3.5	14
M-11-43-414	4	14

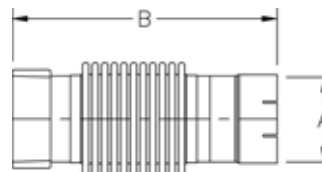

Slotted ID Cuff / Slotted ID Cuff

Part Number	A	B
M-11-44-3518	3.5	18
M-11-44-418	4	18
M-11-44-518	5	18
M-11-44-618	6	18
M-11-44-818	8	18
M-11-44-1018	10	18
M-11-44-1218	12	18

Tube ends may be substituted.

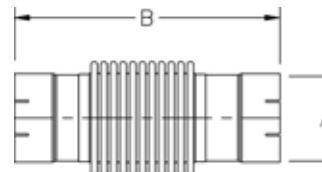

All dimensions are in inches. Other sizes available. All ANSI flanges may be replaced with a standard Caterpillar, Cummins, or MTU engine flanges. Bellows are 321 stainless steel. End connections are carbon steel. Connections available in stainless steel. Bellows flow liners are recommended for exhaust 6" and below when gas/stream flow conditions are greater than available in stainless steel. or equal to 4 ft/second/inch of diameter and for exhaust 8" and above when gas/stream flow conditions are greater than or equal to 25 ft/second.

M-11 BELLOWS

Expansion Joints / Bellows

Floating ANSI Flange / 90° Elbow / Floating ANSI Flange

Part Number	A	B	C
M-11-1F61F-400-B45C16	4	4.5	16
M-11-1F61F-500-B55C16	5	5.5	16
M-11-1F61F-600-B65C18	6	6.5	18
M-11-1F61F-800-B9C18	8	9	18
M-11-1F61F-1000-B11C24	10	11	24
M-11-1F61F-1200-B13C24	12	13	24

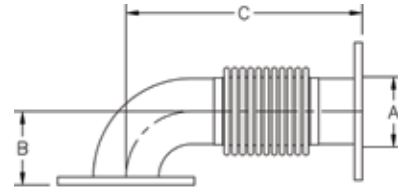

Floating ANSI Flange / 90° Elbow / Slotted ID Cuff

Part Number	A	B	C
M-11-1F64-400-B45C18	4	4.5	18
M-11-1F64-500-B55C18	5	5.5	18
M-11-1F64-600-B65C20	6	6.5	20

Tube ends may be substituted.

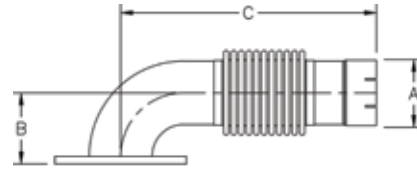

Flared Flange / 90° Elbow / Floating ANSI Flange

Part Number	A	B	C
M-11-761F-500-B8C18	5	8	18
M-11-761F-600-B9C18	6	9	18

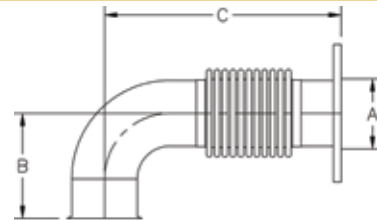

Flared Flange / 90° Elbow / Slotted ID Cuff

Part Number	A	B	C
M-11-764-350-B5C18	3.5	5	18
M-11-764-400-B5.5C18	4	5.5	18
M-11-764-500-B8C20	5	8	20
M-11-764-600-B9C22	6	9	22

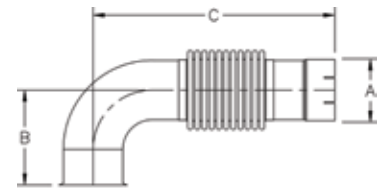

Machined Turbo Flange / 90° Elbow / Floating ANSI Flange

Part Number	A	B	C
M-11-861F-500-B6.63C18	5	6.63	18
M-11-861F-600-B7.63C18	6	7.63	18
M-11-DD-861F-600-B9.47C20	6	9.47	20

Both 5" and 6" connectors are equipped with a 5" machined turbo flange.

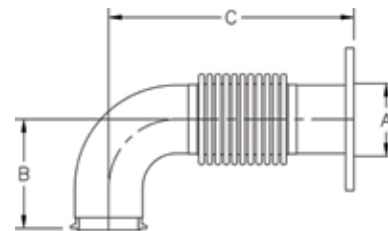

All dimensions are in inches. Other sizes available. All ANSI flanges may be replaced with a standard Caterpillar, Cummins, or MTU engine flanges. Bellows are 321 stainless steel. End connections are carbon steel. Connections available in stainless steel. Bellows flow liners are recommended for exhaust 6" and below when gas/stream flow conditions are greater than available in stainless steel. or equal to 4 ft/second/inch of diameter and for exhaust 8" and above when gas/stream flow conditions are greater than or equal to 25 ft/second.

