

# ABSORPTIVE VENT AND BLOWDOWN SILENCER

## 50 to 55 dBA Noise Reduction

### OVERVIEW

The VT3 is the best silencing option for high frequency noise associated with venting pressurized gas to the atmosphere. The VT3 provides the maximum noise reduction that can be practically obtained. The VT series can be engineered and designed to your specific project or end user requirements and specifications.

Typical Applications: Process plants for gas, fluids and steam, Safety and relief valve discharge, Compressor and gas transmission line blowdown plus Pipeline and petrochemical industries

### FEATURES

- Advanced acoustical design
- Heavy duty, all welded construction and long service life
- Long strand fiberglass acoustical packing
- Flanged inlet nozzle with diffuser
- High heat silicone black or aluminum finish
- NPT drain coupling
- Custom sizes available

### OPTIONS / ACCESSORIES

- AMSE Section VIII, Div. 1 code diffuser
- Side inlet connection
- Multiple flanges and classes available
- Multiple inlets
- Horizontal or vertical support arrangements
- Stainless steel construction
- Custom surface prep and coating
- Weatherhood and birdscreen
- Metallic wool packing available
- Complete range of complimentary accessories

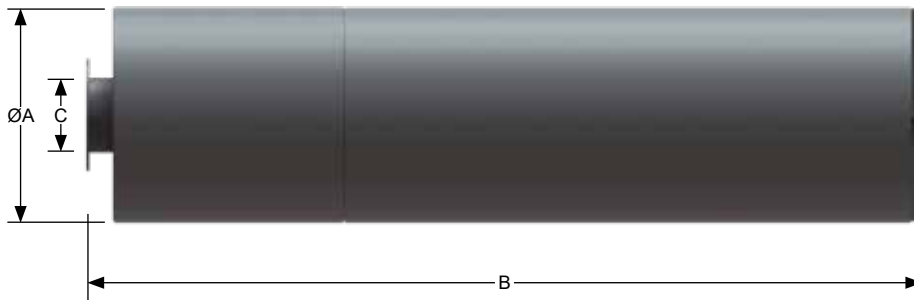
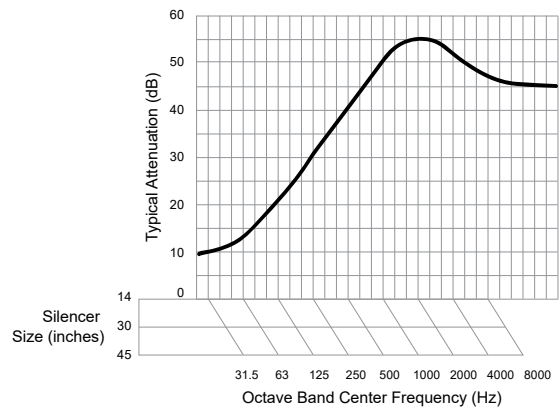

VT3					VT3				
Part No.*	Size / ØA	B	C	Est Wt	Part No.*	Size / ØA	B	C	Est Wt
VT3-14	14	80	4	315	VT3-72	72	186	18	7900
VT3-18	18	95	6	458	VT3-78	78	187	18	9000
VT3-22	22	123	6	732	VT3-86	86	188	20	10600
VT3-26	26	137	8	1034	VT3-96	96	187	20	12750
VT3-30	30	161	10	1768	VT3-104	104	204	24	15350
VT3-36	36	190	12	2656	VT3-112	112	206	24	17050
VT3-40	40	213	14	3467	VT3-120	120	205	24	18950
VT3-45	45	241	16	4487	VT3-128	128	221	24	22550
VT3-54	54	185	16	5250	VT3-136	136	222	24	24700
VT3-64	64	185	16	6700	VT3-144	144	223	24	26900

• All dimensions are in inches. All weights are in pounds. Weights are approximate.  
 • Listed sound data is based on typical performance and should not be considered absolute.  
 • \*See nomenclature guide for additional information on part number creation.