

M-10 FLEX CONNECTORS

Corrugated Flex Connectors

Floating ANSI Flange / ANSI Flange

| Part Number | A | B | WT |
|---------------|-----|----|----|
| M-10-1F1-3518 | 3.5 | 18 | 18 |
| M-10-1F1-418 | 4 | 18 | 20 |
| M-10-1F1-518 | 5 | 18 | 24 |
| M-10-1F1-618 | 6 | 18 | 28 |
| M-10-1F1-818 | 8 | 18 | 39 |
| M-10-1F1-1018 | 10 | 18 | 51 |
| M-10-1F1-1218 | 12 | 18 | 64 |

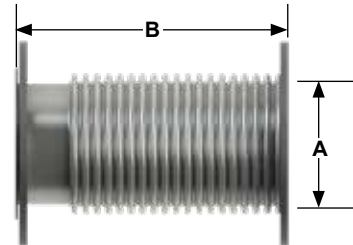

Male NPT / ANSI Flange

| Part Number | A | B | WT |
|--------------|-----|----|----|
| M-10-21-218 | 2 | 18 | 9 |
| M-10-21-2518 | 2.5 | 18 | 10 |
| M-10-21-318 | 3 | 18 | 12 |
| M-10-21-3518 | 3.5 | 18 | 14 |
| M-10-21-418 | 4 | 18 | 16 |

Threaded pipe nipples may be replaced with plain pipe stubs.

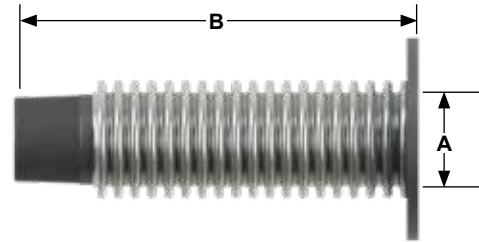

Male NPT / Male NPT

| Part Number | A | B | WT |
|--------------|-----|----|----|
| M-10-22-218 | 2 | 18 | 6 |
| M-10-22-2518 | 2.5 | 18 | 6 |
| M-10-22-318 | 3 | 18 | 8 |
| M-10-22-3518 | 3.5 | 18 | 10 |
| M-10-22-418 | 4 | 18 | 11 |

Threaded pipe nipples may be replaced with plain pipe stubs.

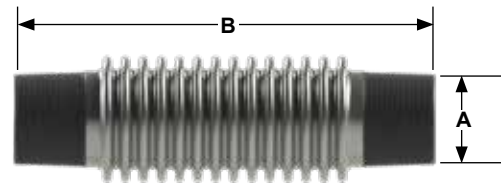

Female Half Coupling / ANSI Flange

| Part Number | A | B | WT |
|--------------|-----|----|----|
| M-10-31-218 | 2 | 18 | 9 |
| M-10-31-2518 | 2.5 | 18 | 10 |
| M-10-31-318 | 3 | 18 | 12 |
| M-10-31-3518 | 3.5 | 18 | 15 |
| M-10-31-418 | 4 | 18 | 16 |

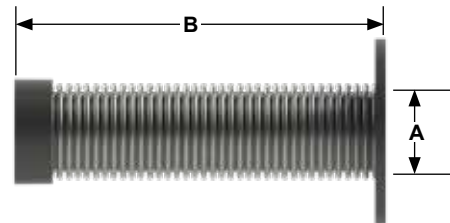

- All dimensions are in inches. All weights are in pounds. Weights are approximate.
- Other sizes available, call for details.
- All ANSI flanges may be replaced with a standard Caterpillar, Cummins, or MTU engine flanges.
- Flex is 321 stainless steel. End connections are carbon steel. Connections available in stainless steel.

M-10 FLEX CONNECTORS

Corrugated Flex Connectors

Slotted ID Cuff / ANSI Flange

| Part Number | A | B | WT |
|--------------|-----|----|----|
| M-10-41-218 | 2 | 18 | 9 |
| M-10-41-2518 | 2.5 | 18 | 10 |
| M-10-41-318 | 3 | 18 | 10 |
| M-10-41-3518 | 3.5 | 18 | 13 |
| M-10-41-418 | 4 | 18 | 14 |
| M-10-41-518 | 5 | 18 | 16 |
| M-10-41-618 | 6 | 18 | 19 |

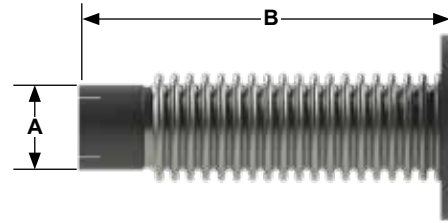

Slotted ID Cuff / Male NPT

| Part Number | A | B | WT |
|--------------|-----|----|----|
| M-10-42-218 | 2 | 18 | 5 |
| M-10-42-2518 | 2.5 | 18 | 6 |
| M-10-42-318 | 3 | 18 | 7 |
| M-10-42-3518 | 3.5 | 18 | 8 |
| M-10-42-418 | 4 | 18 | 9 |

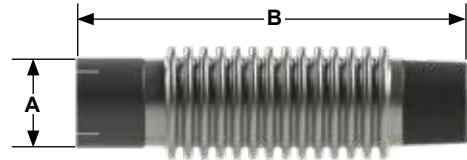

Threaded pipe nipples may be replaced with plain pipe stubs.

Slotted ID Cuff / Female Half Coupling

| Part Number | A | B | WT |
|--------------|-----|----|----|
| M-10-43-218 | 2 | 18 | 5 |
| M-10-43-2518 | 2.5 | 18 | 6 |
| M-10-43-318 | 3 | 18 | 6 |
| M-10-43-3518 | 3.5 | 18 | 8 |
| M-10-43-418 | 4 | 18 | 9 |

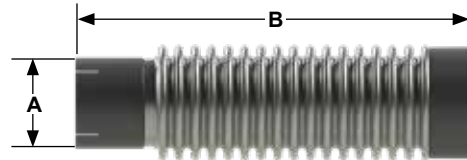

Slotted ID Cuff / Slotted ID Cuff

| Part Number | A | B | WT |
|--------------|-----|----|----|
| M-10-44-218 | 2 | 18 | 5 |
| M-10-44-2518 | 2.5 | 18 | 5 |
| M-10-44-318 | 3 | 18 | 5 |
| M-10-44-3518 | 3.5 | 18 | 6 |
| M-10-44-418 | 4 | 18 | 7 |
| M-10-44-518 | 5 | 18 | 8 |
| M-10-44-618 | 6 | 18 | 10 |
| M-10-44-818 | 8 | 18 | 12 |
| M-10-44-1018 | 10 | 18 | 17 |

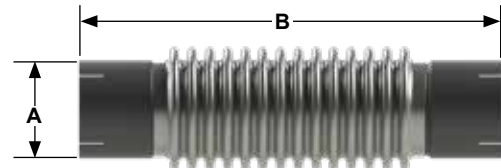

Tube ends may be substituted

- All dimensions are in inches. All weights are in pounds. Weights are approximate.
- Other sizes available, call for details.
- All ANSI flanges may be replaced with a standard Caterpillar, Cummins, or MTU engine flanges.
- Flex is 321 stainless steel. End connections are carbon steel. Connections available in stainless steel.



M-10 FLEX CONNECTORS

Corrugated Flex Connectors

Floating ANSI Flange / 90° Elbow / Floating ANSI Flange

| Part Number | A | B | C | WT |
|------------------------|----|-----|----|----|
| M-10-1F61F-600-B65C18 | 6 | 6.5 | 18 | 27 |
| M-10-1F61F-800-B9C24 | 8 | 9 | 24 | 48 |
| M-10-1F61F-1000-B11C24 | 10 | 11 | 24 | 63 |
| M-10-1F61F-1200-B13C24 | 12 | 13 | 24 | 84 |

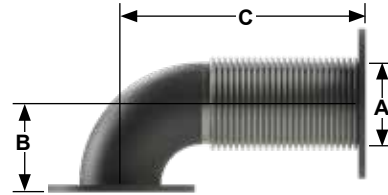

Floating ANSI Flange / 90° Elbow / Slotted ID Cuff

| Part Number | A | B | C | WT |
|----------------------|---|-----|----|----|
| M-10-1F64-400-B45C18 | 4 | 4.5 | 18 | 14 |
| M-10-1F64-500-B55C19 | 5 | 5.5 | 19 | 18 |
| M-10-1F64-600-B65C20 | 6 | 6.5 | 20 | 22 |

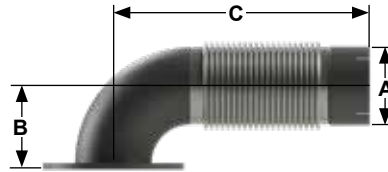

Flared Flange / 90° Elbow / Floating ANSI Flange

| Part Number | A | B | C | WT |
|------------------------|---|---|-------|----|
| M-10-761F-500-B8C23.25 | 5 | 8 | 23.25 | 19 |
| M-10-761F-600-B9C24.50 | 6 | 9 | 24.50 | 23 |

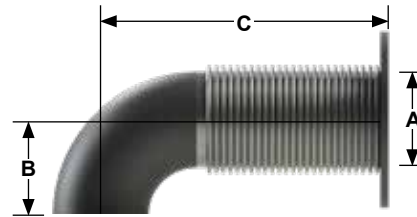

Flared Flange / 90° Elbow / Slotted ID Cuff

| Part Number | A | B | C | WT |
|----------------------|-----|-----|----|----|
| M-10-764-350-B5C18 | 3.5 | 5 | 18 | 7 |
| M-10-764-400-B5.5C18 | 4 | 5.5 | 18 | 9 |
| M-10-764-500-B8C20 | 5 | 8 | 20 | 12 |
| M-10-764-600-B9C22 | 6 | 9 | 22 | 16 |

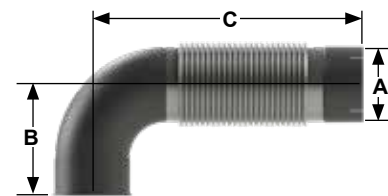

Machined Turbo Flange / 90° Elbow / Floating ANSI Flange

| Part Number | A | B | C | WT |
|---------------------------|---|------|-------|----|
| M-10-861F-500-B6.63C23.25 | 5 | 6.63 | 23.25 | 21 |
| M-10-861F-600-B7.63C24.50 | 6 | 7.63 | 24.50 | 26 |

Both 5" and 6" connectors are equipped with a 5" machined turbo flange.

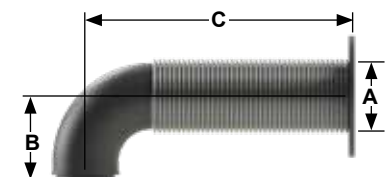

- All dimensions are in inches. All weights are in pounds. Weights are approximate.
- Other sizes available, call for details.
- All ANSI flanges may be replaced with a standard Caterpillar, Cummins, or MTU engine flanges.
- Flex is 321 stainless steel. End connections are carbon steel. Connections available in stainless steel.