

# ATMOSPHERIC VENT SILENCER

## 35 to 40 dBA Noise Reduction

### OVERVIEW

The VT1 is good for vent silencing of high frequency noise associated with steam or gas vents. The VT1 has a very high performance to cost ratio. Installation of the VT1 on a high pressure safety valve discharge will satisfy most concerns regarding worker safety or OSHA noise compliance. The VT series can be engineered and designed to your specific project or end user requirements and specifications.

Typical Applications: Process vents, safety and relief valve discharge, small process vents, as well as compressor and gas transmission line blowdown

### FEATURES

- Advanced acoustical design
- Heavy duty, all welded construction and long service life
- Long strand fiberglass acoustical packing
- Flanged inlet nozzle with diffuser
- High heat silicone black or aluminum finish
- NPT drain coupling
- Custom sizes available

### OPTIONS / ACCESSORIES

- AMSE Section VIII, Div. 1 code diffuser
- Side inlet connection
- Multiple flanges and classes available
- Multiple inlets
- Horizontal or vertical support arrangements
- Stainless steel construction
- Custom surface prep and coating
- Weatherhood and birdscreen
- Metallic wool packing available
- Complete range of complimentary accessories

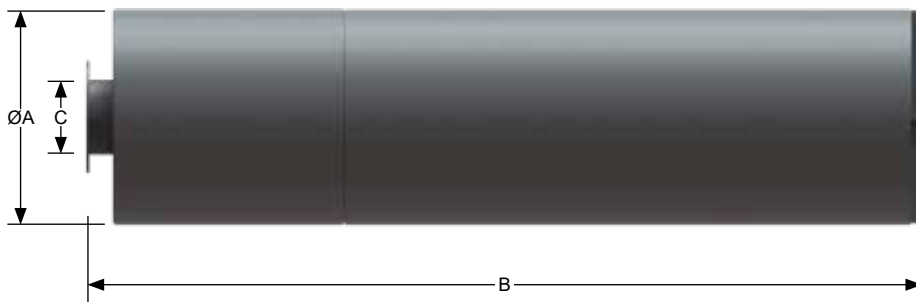
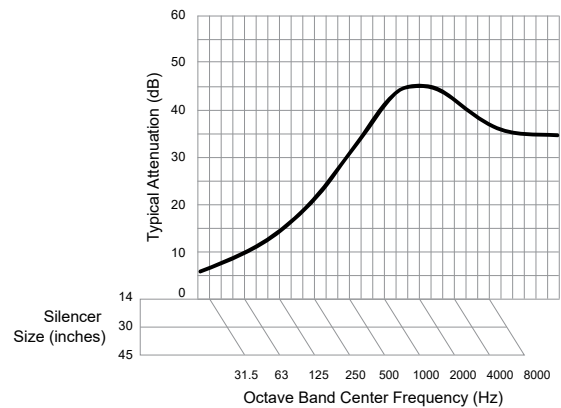

VT1					VT1				
Part No.*	Size / ØA	B	C	Est Wt	Part No.*	Size / ØA	B	C	Est Wt
VT1-14	14	44	4	175	VT1-72	72	114	18	4700
VT1-18	18	53	6	265	VT1-78	78	115	18	5300
VT1-22	22	63	6	465	VT1-86	86	116	20	6250
VT1-26	26	71	8	575	VT1-96	96	115	20	7550
VT1-30	30	83	10	945	VT1-104	104	132	24	9400
VT1-36	36	99	12	1415	VT1-112	112	134	24	10350
VT1-40	40	110	14	1840	VT1-120	120	133	24	11350
VT1-45	45	127	16	2525	VT1-128	128	149	24	13950
VT1-54	54	112	16	3200	VT1-136	136	150	24	15500
VT1-64	64	113	16	4050	VT1-144	144	151	24	16400

• All dimensions are in inches. All weights are in pounds. Weights are approximate.  
 • Listed sound data is based on typical performance and should not be considered absolute.  
 • \*See nomenclature guide for additional information on part number creation.

